

# FGM Service FLOWMETER

Flowmeter controller for Lubrication Points

Technical Data Sheet



FGM Service S.A.S., Via Adamello 15, I-20027 Rescaldina (MI), Italy, declare that the FLOW TRANSMITTER AL Art. No. FS01 and that the FLOW TRANSMITTER SS Art. No. FS01.AISI is designed and manufactured in accordance with EUROPEAN ROHS DIRECTIVE 2011/65/EU EUROPEAN WEEE DIRECTIVE 2012/19/EU

1. General Description

**Operating principle**

The meter operates using a rotating oval gear mechanism with embedded magnets that produce a pulsed output, precisely reflecting the volumetric flow rate.

It is specifically designed for use in critical lubrication points, where flow rates are relatively low, and pressure is high.

When paired with a PLC system, the flowMeter enables the calculation of instantaneous flow rates by measuring the time intervals between pulses. Additionally, a totalizing counter can be easily implemented by simply counting the pulses.

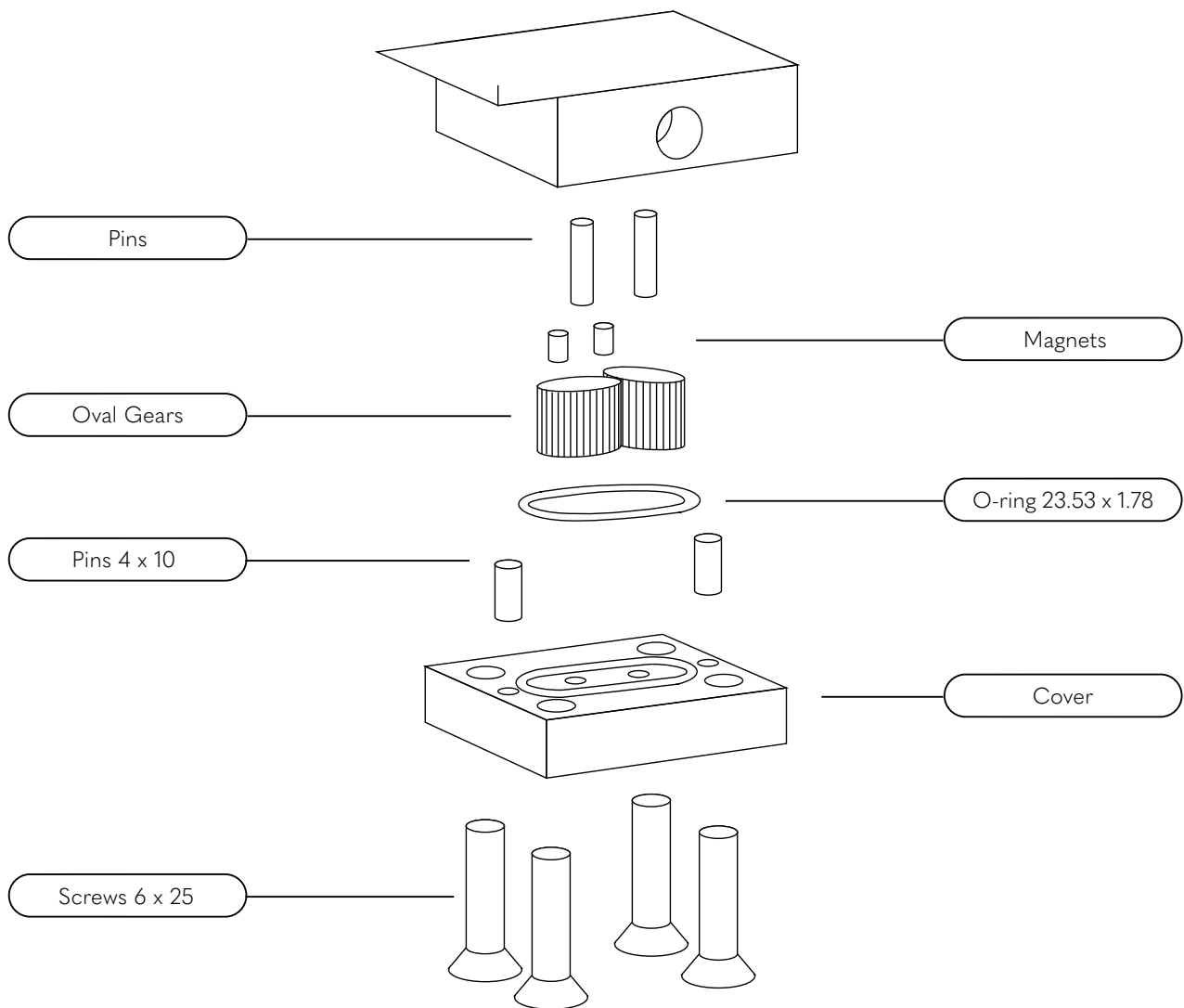

### 2. Ordering Codes



FS01	FS01.AISI	CC12-5	C12-M90
Anodized aluminum	AISI 316 Stainless Steel	Elbow Cable M12x1 (5 m)	Elbow Connector M12x1

### 2.1 Dati Tecnici

<b>Dimensions</b>	Excluding connector (LxWxH): 55 x 40 x 38
<b>Connection</b>	ISO-G 1/8"
<b>Material</b>	Anodized aluminum, Art. no. FS01 Stainless steel AISI 316, Art. no. FS01.AISI
<b>Weight</b>	0.186 kg (Aluminum), 0.485 kg (Stainless Steel)
<b>Flow Rate</b>	0 - 2500 cm <sup>3</sup> /min
<b>Working Temperature</b>	-20 °C - +70 °C
<b>Vibration</b>	20 G (10-20000 Hz)
<b>Lifetime</b>	10 <sup>7</sup> pulses, approximately equivalent to 6.5 m <sup>3</sup> (reed sensor). To achieve maximum life, power must be <10 mA.
<b>Accuracy</b>	NLGI 2 Grease: 0.655 cm <sup>3</sup> /pulse ±3% ISO VG 150 Oil: 0.610 cm <sup>3</sup> /pulse ±3%

### 2.2 Electrical data

<b>IP Class</b>	IP 67
<b>Connection</b>	4-pole std. M12x1 (M), signal on pins 1 and 4
<b>Voltage</b>	0 - 24 V DC
<b>Power</b>	max. 0.20 A

### 2.3 Connection

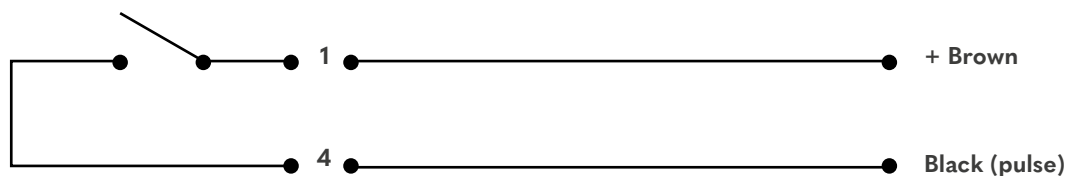

3. FS01 Dimensions

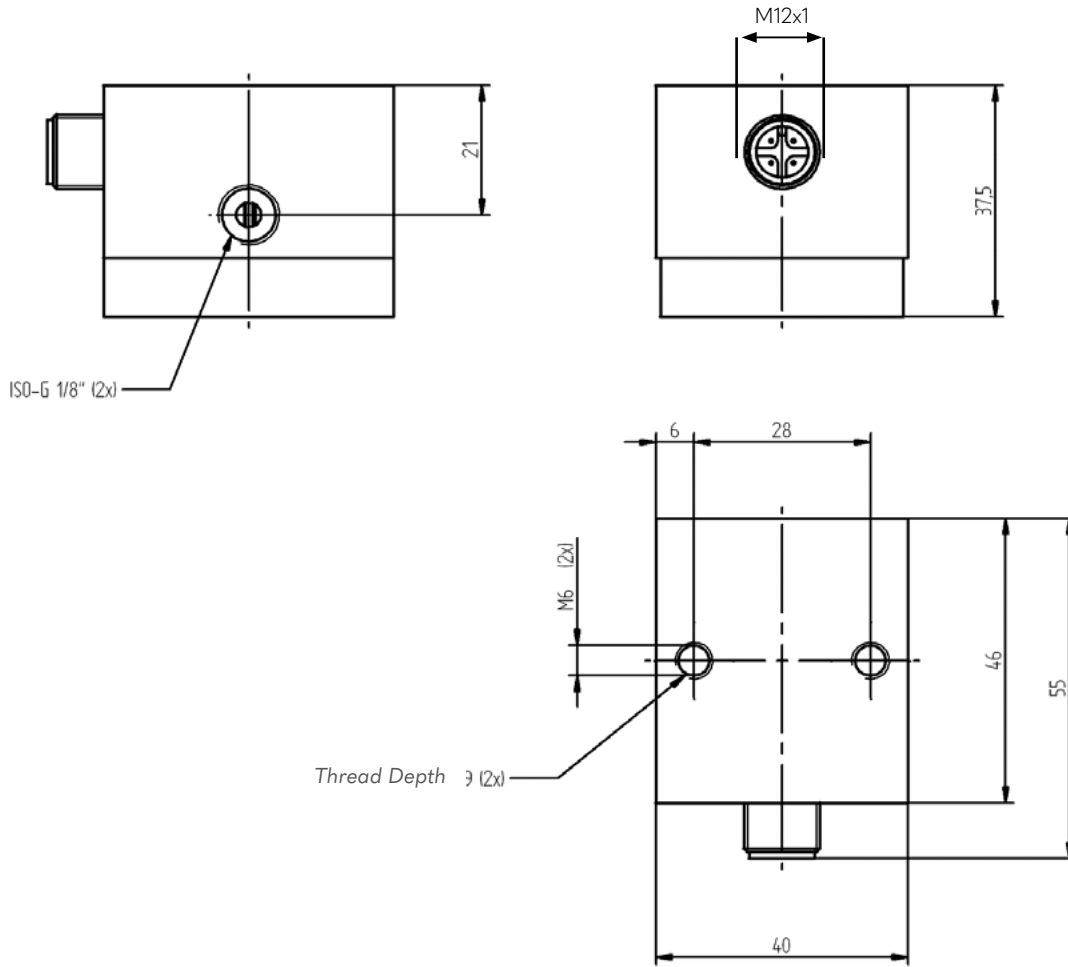

4. Elbow Cable Dimensions and connections CC12-5 + optional C12-M90

